

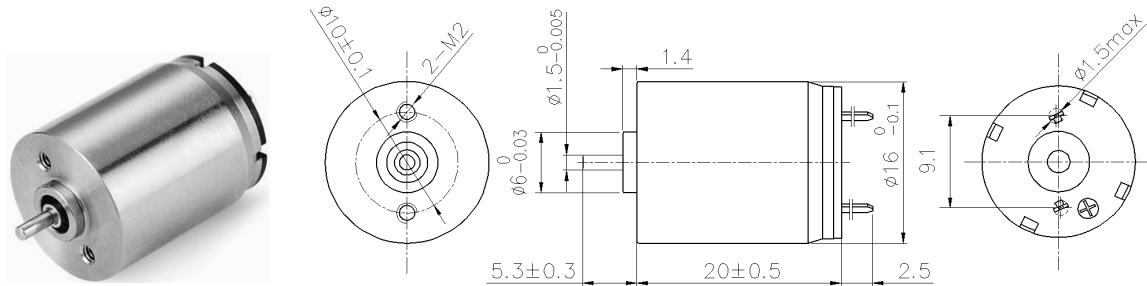

Coreless Brush DC Motor

LS-1620R



Typical Applications: Eyebrow Tattoo Machine, Electric polisher, Robot

电机参数 (Motor data)		19A	21A	06A		
额定电压下数值 (Values at nominal voltage)						
1 额定电压 (Nominal voltage)	V	3	12	12		
2 空载转速 (No load speed)	rpm	4650	7120	12000		
3 空载电流 (No load current)	mA	10	10	20		
4 额定转速 (Nominal speed)	rpm	4231	4750	8820		
5 额定转矩 (最大连续转矩) (Nominal torque)	mNm	2	2	2		
6 额定电流 (最大连续电流) (Nominal current)	A	0.043	0.13	0.228		
7 堵转转矩 (Stall torque)	mNm	2.20	6	7.5		
8 堵转电流 (Stall current)	A	0.38	0.38	0.8		
9 最大效率 (Max efficiency)	%	74	72	74		
电机常数 (Motor constant)						
10 相间电阻 (Terminal resistance)	Ω	8.0	31.2	14.93		
11 转矩常数 (Torque constant)	mNm/A	6.04	15.77	9.36		
12 速度常数 (Speed constant)	rpm/V	1550	593	1000		

其他特性参数 Other characteristic parameters

13 环境温度范围 (Ambient temperature)	-10~40℃
14 绕组最高允许温度 (Max permissible winding temperature)	80℃
15 最高允许转速 (Max permissible speed)	20000rpm
16 电极磁极对数 (Number of the pole pairs)	1
17 换向器片数 (Number of the commutator segments)	5
18 电机质量 (Weight)	18g

19A电机曲线图 motor curve

