

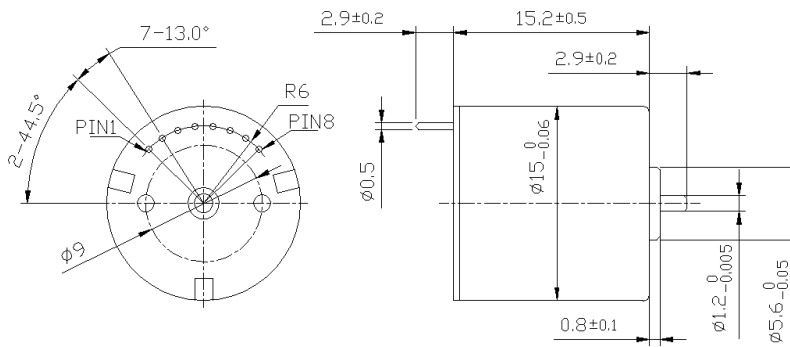

Coreless Brushless DC Motor

LS-1515RB



Typical Applications: Door lock, Robot, RC servo

| 电机参数 (Motor data) | | 03A | 06A | 12C | | |
|-------------------------------------|-------|-------|-------|-------|--|--|
| 额定电压下数值 (Values at nominal voltage) | | | | | | |
| 1 额定电压 (Nominal voltage) | V | 6 | 7.4 | 7.4 | | |
| 2 空载转速 (No load speed) | rpm | 29560 | 32720 | 37000 | | |
| 3 空载电流 (No load current) | mA | 250 | 230 | 220 | | |
| 4 额定转速 (Nominal speed) | rpm | 22280 | 25500 | 33300 | | |
| 5 额定转矩(最大连续转矩) (Nominal torque) | mNm | 1.4 | 1.4 | 0.91 | | |
| 6 额定电流(最大连续电流) (Nominal current) | A | 0.9 | 0.85 | 0.64 | | |
| 7 堵转转矩 (Stall torque) | mNm | 6.0 | 6.3 | 9.1 | | |
| 8 堵转电流 (Stall current) | A | 3.40 | 3.13 | 4.8 | | |
| 9 最大效率 (Max efficiency) | % | 61 | 61 | 69 | | |
| 电机常数 (Motor constant) | | | | | | |
| 10 相间电阻 (Terminal resistance) | Ω | 1.77 | 2.36 | 1.55 | | |
| 11 转矩常数 (Torque constant) | mNm/A | 1.90 | 2.12 | 1.87 | | |
| 12 速度常数 (Speed constant) | rpm/V | 4927 | 4422 | 5000 | | |

其他特性参数 Other characteristic parameters

- 13 环境温度范围 (Ambient temperature) -10~40°C
- 14 绕组最高允许温度 (Max permissible winding temperature) 120°C
- 15 最高允许转速 (Max permissible speed) 35000rpm
- 16 电极磁极对数 (Number of the pole pairs) 1
- 17 相数 (Number of Phases) 3
- 18 电机质量 (Weight) 12.6g

端子定义 (terminals):

- PIN1 C
- PIN2 GND
- PIN3 HB
- PIN4 HA
- PIN5 B
- PIN6 VCC
- PIN7 HC
- PIN8 A

03A电机曲线图 motor curve

