



DC Planetary Gear Motor

PG28BL28



Appearance size

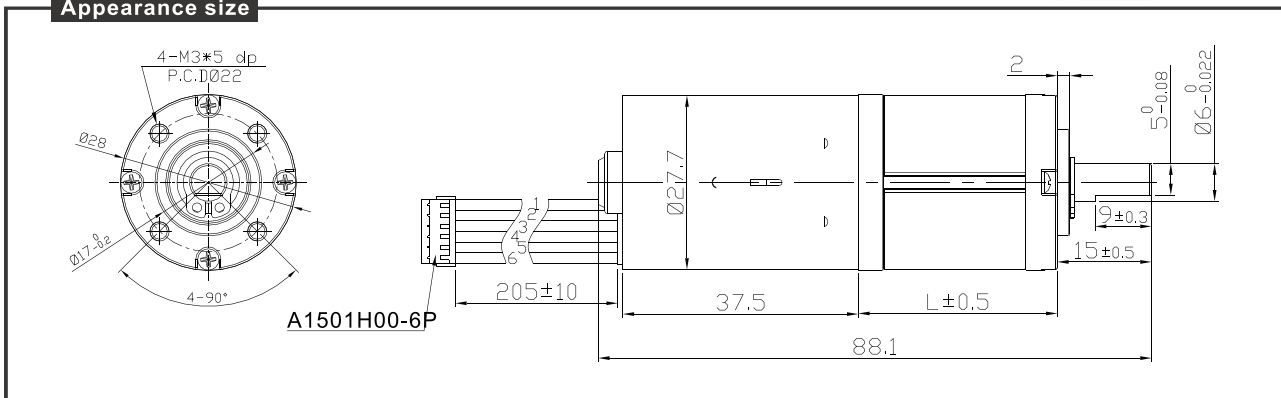

Gearbox data:

Number of stages	1 stages reduction	2 stages reduction	3 stages reduction	4stages reduction	5stages reduction
Reduction ratio	3.3, 4.6	11.2, 15.5, 21.5	37.7, 52.1, 72, 100	126, 174, 241, 334, 462,	423, 585, 810, 1120, 1549, 2142,
Gearbox length "L" mm	20.2	25.9	31.7	37.5	43.3
Max. Running torque	10Kgf · cm	20Kgf · cm	50Kgf · cm	50Kgf · cm	50Kgf · cm
Max. Gear breaking torque	20Kgf · cm	60Kgf · cm	150Kgf · cm	150Kgf · cm	150Kgf · cm
Gearing efficiency	90%	81%	73%	65%	59%

Motor data:

Motor name	Rated Volt. V	No load		Load torque				Stall torque	
		Current	Speed	Current	Speed	Torque	Output power	Torque	Current
		mA	r/min	mA	r/min	gf · cm	W	gf · cm	mA
BL28-246000	24	≤90	6000	≤270	5152	79.3	4.1	507	1380
BL28-126000	12	≤100	6000	≤280	5157	80.7	4.3	515	1383

1. After connecting motor and gearbox which is named gearmotor the output torque: motortorque X reduction ratio X gearing efficiency; output speed: motor speed / reduction ratio.

电机使用示意图

