



Planetary Geared Stepper Motor

LS-36PA/42BYG

Housing Material: Metal
 Backlash at No Load: $\leq 1^\circ$
 Bearing at Output: Ball or Sleeve
 Permissible Overhung Load: $\leq 10\text{kg}$
 Permissible Thrust Load: $\leq 5\text{kg}$
 Max.Radial Play: $\leq 0.05\text{mm}$
 Max.Thrust Play: $\leq 0.3\text{mm}$



Motor Data

Model	Step Angle	Length (Ld)	Phase Voltage	Phase Current	Phase Resistance	Phase Inductance	Holding Torque	Lead Wire
	($^\circ$)	mm	V	A	Ω	mH	g.cm	#
42BYGH34(M)-040-4A/B	1.8/0.9	34	12	0.40	30	37	2200	4
42BYGH40(M)-040-6A/B	1.8/0.9	40	12	0.40	30	21	2570	6
42BYGH40(M)-160-4A/B	1.8/0.9	40	2.78	1.60	1.73	3.2	3600	4
42BYGH48(M)-040-6A/B	1.8/0.9	48	12	0.40	30	25	3200	6
42BYGH48(M)-120-4A/B	1.8/0.9	48	3.6	1.20	3	5	4500	4

Gearbox Data

Exact Reduction Ratio

Reduction Ratio	X:1	4	5	13	19	27	51	71	100	139
Exact Reduction Ratio	X:1	$3\frac{12}{17}$	$5\frac{2}{11}$	$13\frac{212}{289}$	$19\frac{38}{187}$	$26\frac{103}{121}$	$51\frac{4397}{4913}$	$71\frac{2}{25}$	$99\frac{1044}{2057}$	$136\frac{184}{1221}$
Number of gear trains	#	1	1	2	2	2	3	3	3	3
Max Permissible Torque	kg.cm	20	20	30	30	30	40	40	40	40
Moment Permissible Torque	kg.cm	40	40	50	50	50	60	60	60	60
Gear Box Length	mm	30	30	38	38	38	46	46	46	46

Mechanical Dimensions

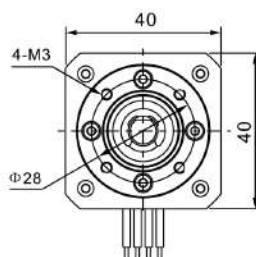
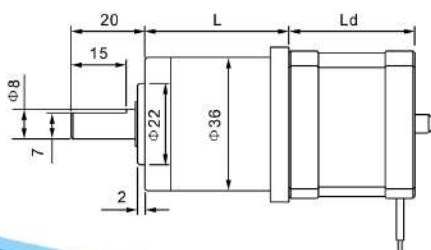

4(6)Leads

